

# Existing Housing: Stockyard District

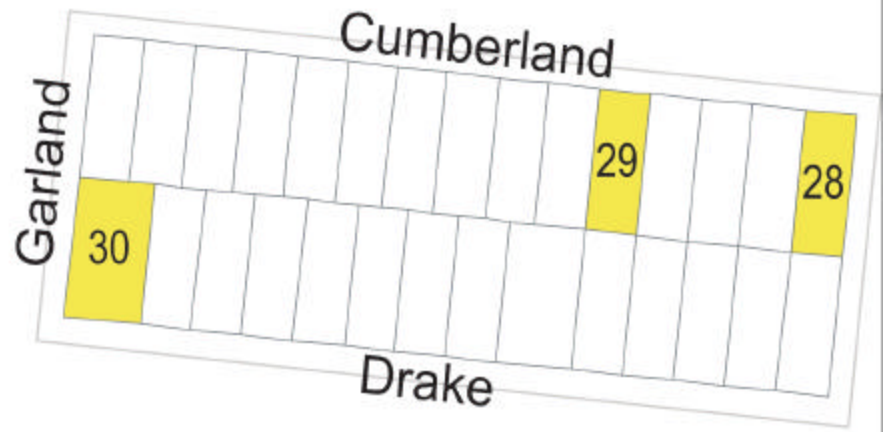

**25** 518 Cumberland Boulevard  
 Year Built: 1930  
 Total Lot Square Footage: 6,550  
 Living Area Square Footage: 1,052  
 Characteristics: Attached Open Porch, Detached Garage, Asbestos Siding

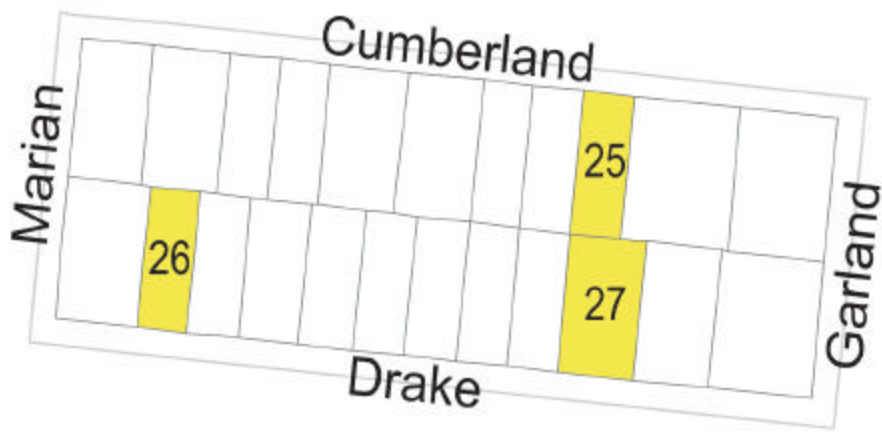

**28** 400 Cumberland Boulevard  
 Year Built: 1923  
 Total Lot Square Footage: 6,550  
 Living Area Square Footage: 1,194  
 Characteristics: Attached Open Porch, Terrace Asbestos Siding



**26** 551 Drake Avenue  
 Year Built: 1941  
 Total Lot Square Footage: 6,550  
 Living Area Square Footage: 840  
 Characteristics: Attached Open Porch, Wood Siding, Detached Garage, Detached Carport



**29** 418 Cumberland Boulevard  
 Year Built: 1925  
 Total Lot Square Footage: 6,500  
 Living Area Square Footage: 1,172  
 Characteristics: Attached Open Porch, Detached Garage



**27** 519 Drake Avenue  
 Year Built: 1942  
 Total Lot Square Footage: 9,825  
 Living Area Square Footage: 1,270  
 Characteristics: Attached Open Porch, Wood Siding, Attached Garage, Attached Open Porch, Terrace



**30** 459 Drake Avenue  
 Year Built: 1924  
 Total Lot Square Footage: 9,750  
 Living Area Square Footage: 1,702  
 Characteristics: Attached Open Porch, Asbestos Siding, Detached Carport, Shed, Terrace, Detached Garage