

Existing Housing: Stockyard District

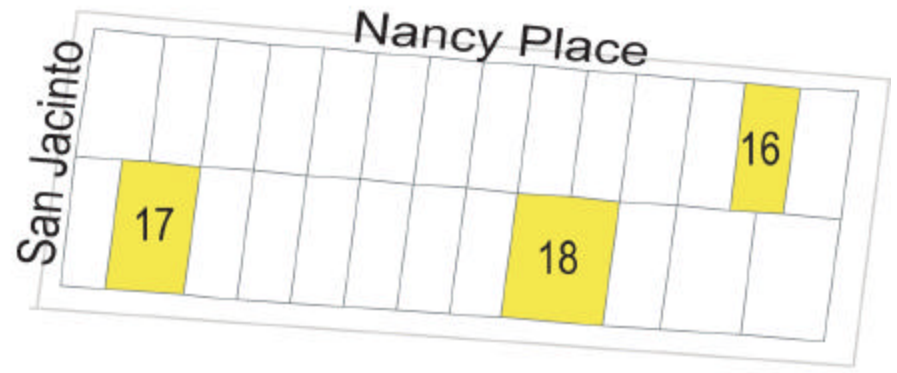

13 206 Wingate Avenue
 Year Built: 1925
 Total Lot Square Footage: 7,000
 Living Area Square Footage: 1,436
 Characteristics: Attached Carport, Terrace

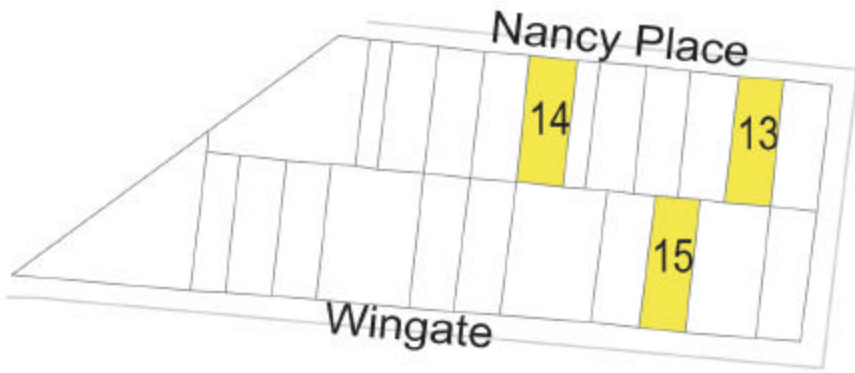

16 104 Nancy Place Avenue
 Year Built: 1946
 Total Lot Square Footage: 7,000
 Living Area Square Footage: 795
 Characteristics: Attached Open Porch
 Wood Siding



14 224 Nancy Place Avenue
 Year Built: 1930
 Total Lot Square Footage: 7,000
 Living Area Square Footage: 790
 Characteristics: Attached Open Porch, Detached
 Garage, Wood Siding



17 151 Wingate Avenue
 Year Built: 1945
 Total Lot Square Footage: 10,500
 Living Area Square Footage: 754
 Characteristics: Attached Open Porch, Asbestos
 Siding, Detached Garage, Shed



15 207 Wingate Avenue
 Year Built: 1915
 Total Lot Square Footage: 7,000
 Living Area Square Footage: 664
 Characteristics: Attached Open Porch, Detached
 Garage, Wood Siding, Detached
 Patio, Detached Carport



18 117 Wingate Avenue
 Year Built: 1924
 Total Lot Square Footage: 14,000
 Living Area Square Footage: 1,176
 Characteristics: Attached Open Porch, Detached
 Garage, Shed